

Mini Mover

Conveyors

**Compact Integral Drive &
Low Profile Modular Conveyors**

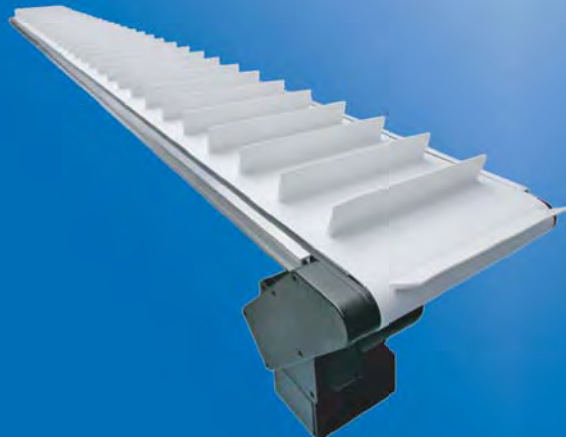



Modern, automated manufacturing & assembly facility



Precision components through state-of-the-art machining & finishing processes

Whipple Enterprises began operation in 1949 manufacturing precision parts and assemblies for the medical, electronics, and aerospace industries. In the process of automating the parts handling from automatic machining equipment, a search was initiated in the conveyor marketplace for cost-effective, compact-profile conveyors that offered rapid installation, limited maintenance, and would withstand the rigors of the production machine shop environment. The search results netted little meeting their needs and Whipples' engineering staff developed a conveyor design incorporating these stringent requirements. At first these conveyors were used internally, automating various functions for increased productivity.

Soon after, Mini-Mover Conveyors were introduced to the marketplace with immediate success. Through market input the Mini-Mover product offering expanded rapidly. Today Mini-Mover conveyors are utilized across industry sectors including packaging, assembly automation, metal stamping, product labeling and food processing.



Expert assistance from applications engineering

Mini-Mover products are manufactured at the Whipple facilities in Volcano, California. A complete stock of components and finished conveyors is maintained to allow orders to be shipped quickly. All Mini-Mover conveyors are built to the highest quality standards and include the Whipple, One Year Limited Warranty.

At Mini-Mover Conveyors, we don't think business is cut and dried. It goes beyond just placing an order and receiving the promised goods. We believe in developing long-term business relationships that, in time, build trust, confidence, and the assurance that you will get the right product and services for your application. For fast, courteous service in placing an order, obtaining product specifications or application assistance:

Call (800) 586-4585 or Fax (866) 900-5124

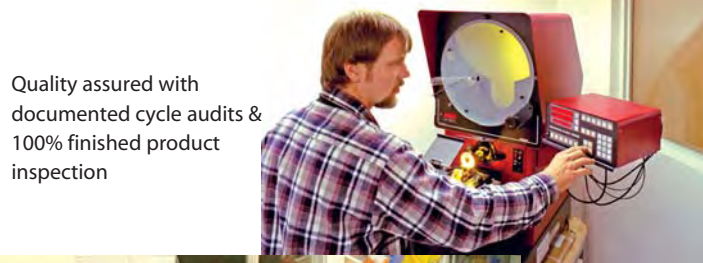

Quality assured with documented cycle audits & 100% finished product inspection



Rapid delivery & cost control through volume build-outs & efficient assembly procedures

Contents

Lite Series Features



Compact Profile
Standard Side Fence 0.70" High
Integral Gearmotor Drives
Drive Controls & Power Cord
Ready to Install Simplicity

LP Series Features



Low Profile, Modular Design
T-Slot Profile Side Frame
Wide Range of Accessories
Variety of Drives & Mounting Styles

Lite Series Conveyors

Specifications	Page 2
Options	Page 3
Ordering Information	Page 4

Conveyor Belts

Conveyor Belt Selection Guide	Page 5
-------------------------------	--------

LP Series Conveyors

Specifications	Page 6
Drive Packages	Page 7
Drive Package Options	Page 8
Ordering Information	Page 9

Accessories

Lite & LP Series Accessories	Page 10
------------------------------	---------

Stands & Mounts

Conveyor Stands & Mounts	Pages 11 & 12
--------------------------	---------------

Standard Model Specifications

- Frame: 2.50 inch high, hard-black-anodized aluminum
- Slider Bed: 0.375 inch polished aluminum
- Pulleys: 1.25 inch dia., precision crowned aluminum
- Pulleys Bearings: Ball bearing, doubled-sealed for life
- Gearmotor: 1/30 to 1/8 HP, 115/60/1 VAC. End drive, Side mount
- Controls: Fixed speed power switch, motor overload fuse, power on LED indicator and 7 ft. power cord & plug housed in junction box mounted to the side frame.
- Conveyor Belts: Select from a variety of standard and cleated belts from the chart on page 5.
- Load Capacity: The Lite series maximum load carrying capacity is 150 pounds. Drive speed has an inverse effect on load capacity. To determine load carrying capacity at a specific belt speed use the drive selection chart on page 4.



Dimensions by Drive HP

HP	A	B	C	D
1/30	0.20"	4.97"	5.19"	3.57"
1/18	0.39"	6.00"	5.57"	3.88"
1/12	0.39"	7.58"	5.57"	3.88"
1/8	0.39"	8.18"	5.57"	3.88"

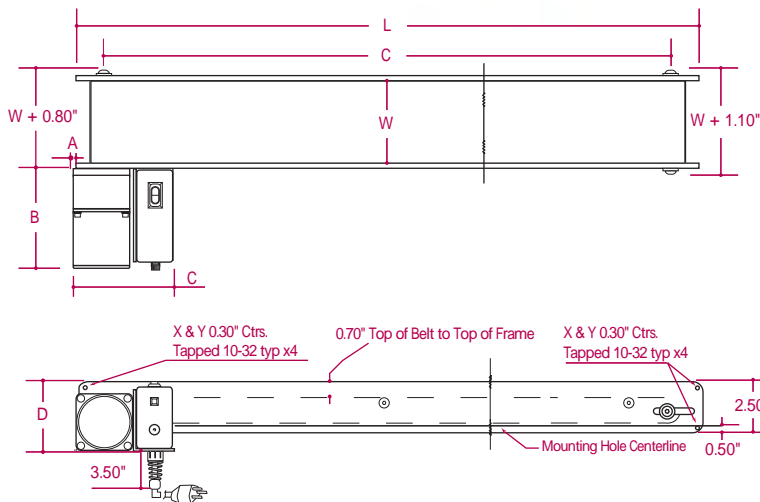

Lite Series Conveyors - Standard Sizes

Conveyor Length Reference	Conveyor Length (L)	Pulley Centers (C)	Conveyor Width Reference	Conveyor Width (W)
018	18.68"	16.15"	02	1.90"
024	24.50"	21.92"	03	2.90"
030	30.52"	27.79"	04	3.90"
036	36.52"	33.98"	06	5.90"
042	42.50"	39.80"	08	7.90"
048	48.76"	46.04"	10	9.90"
060	60.75"	57.85"	12	11.90"
072	72.99"	69.91"	13	12.90"
084	85.23"	82.00"	14	13.90"
096	97.47"	94.06"	15	14.90"
108	109.47"	106.12"	16	15.90"
120	121.50"	118.18"		
132	133.50"	130.24"		
144	145.50"	142.30"		

ND Option

No Drive Package

Supplied without drive or controls. Single drive shaft located on standard side shown. Indicate option "OS" for opposite side drive shaft.

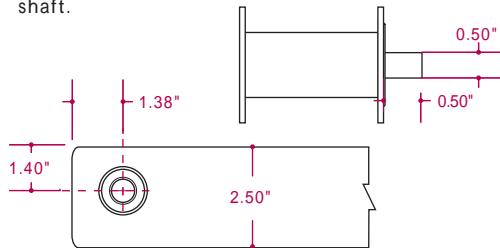

OS Option

Opposite Side, Drive Mounting

Lite Series drives & controls may be mounted on either side rail. The standard side is shown below. For opposite side drive mounting, select option "OS".

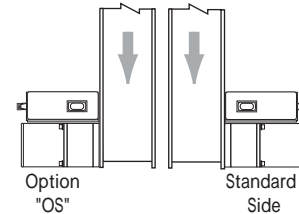

VS Option

Variable Speed Drive



Variable speed drives are available for all Lite Series Conveyors. The drives are variable frequency and include the remote-mount controller shown. The controller accepts 115 VAC input and inverts the output to 230/60/3 phase VAC. Dimensions for the variable speed drives with terminal box may be obtained by ordering SpecsSheet 20104

Inverter / Controller Overview

Inverter is designed exclusively to drive 3-phase induction motors. Combining a 3-phase induction motor with the inverter offers a wide working speed range. All "VS" option conveyors include the Inverter / Controller.

Control Functions

Front Panel	External Control*
Run / Stop Switch	Run / Stop
CW / CCW Direction Switch	Rotational Direction
Speed Control Potentiometer	Free Run Stop

* Remote control functions require an additional cable Order P/N DVOP1390 5 - 5 meter length. Additional switches are required, but not included.

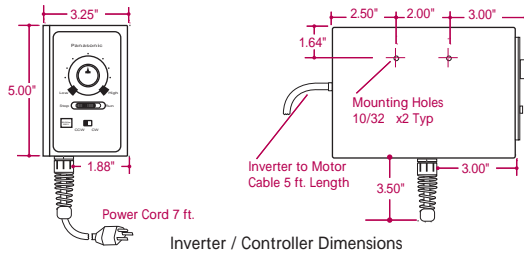

Inverter / Controller Dimensions

Motor Voltage Options

The standard voltage configuration for Lite Series drive packages is 115/60/1 VAC. The standard drive package is supplied with a control box including a power switch, LED indicator, fuse and 7 ft power cord.

T1 Option

Terminal Box Style Motor

Select Option T1 to substitute a 115/60/1 VAC, terminal box style motor without controls.

V1 Option

230/50/60/1 VAC Motor

Select Option V1 to substitute a 230/50/60/1 VAC, terminal box style motor without controls.

V2 Option

230/60/3 VAC Motor

Select Option V2 to substitute a 230/60/3 VAC, terminal box style motor without controls.

Note: Dimensions for the Lite Series Conveyors with terminal box motors may be obtained by ordering SpecsSheet 20103

Standard Drive Selection

Gearmotor Selection Steps

1. Using the Drive HP Selection Guide, select the required HP for the application load & speed.
2. From the Gearmotor Selection Chart, chose a fixed speed or variable speed gearmotor, meeting the application requirement.
3. Use the selected gearmotor reference number when building a conveyor ordering number

Drive HP Selection Guide

Belt Speed FPM	Conveyor Load lbs.												
	10	20	30	40	50	60	70	80	90	100	110	120	130
0-12													
16-23													
32-39													
47-65													
78-98													
117-150													

1/30 HP - 25 Watt A

1/18 HP - 40 Watt B

1/12 HP - 60 Watt C

1/8 HP - 90 Watt D

Note: Load carrying capacity is based on horizontal travel, uniformly distributed load over the usable belt length and the belt moving toward the drive. For inclined applications, for applications with the belt travel away from the drive end, and for application assistance on not cataloged drive packages, please consult your representative.

Gearmotor Selection & Order information

Fixed Speed				Variable Speed-Inverter Included			
Gearmotor Ref No.	HP	Torque In.-lb.	Belt Speed FPM *	Gearmotor Ref No.	HP	Torque In.-lb.	Belt Speed FPM
075A	1/30	69	8	36VA	1/30	34	5 -15
050A	1/30	46	12	25VA	1/30	23	7 -22
036A	1/30	33	16	15VA	1/30	14	12 -37
025A	1/30	23	23	25VB	1/18	39	7 -22
015A	1/30	14	39	15VB	1/18	24	12 -37
036B	1/18	56	16	12VB	1/18	20	17 -44
025B	1/18	39	23	09VB	1/18	14	20 -61
015B	1/18	24	39	07VB	1/18	11	24 -74
012B	1/18	47	47	25VC	1/12	57	7 -22
025C	1/12	23	23	15VC	1/12	34	12 -37
015C	1/12	34	39	12VC	1/12	29	17 -44
012C	1/12	29	47	09VC	1/12	20	20 -61
009C	1/12	21	65	07VC	1/8	17	24 -74
015D	1/8	50	39	15VD	1/8	50	12 -37
012D	1/8	41	47	12VD	1/8	41	17 -44
009D	1/8	30	65	07VD	1/8	25	26 -74
007D	1/8	25	78	06VD	1/8	20	33 -92
006D	1/8	16	98	05VD	1/8	16	38 -110
004D	1/8	12	163	04VD	1/8	12	53 -155

Note: The numbers in the Gearmotor Ref. No. represent the gear head ratio, except 04, which is a 3.6/1 ratio.

* Actual speed is 20-20% less, depending on load

Lite Series, Standard Model Ordering Chart

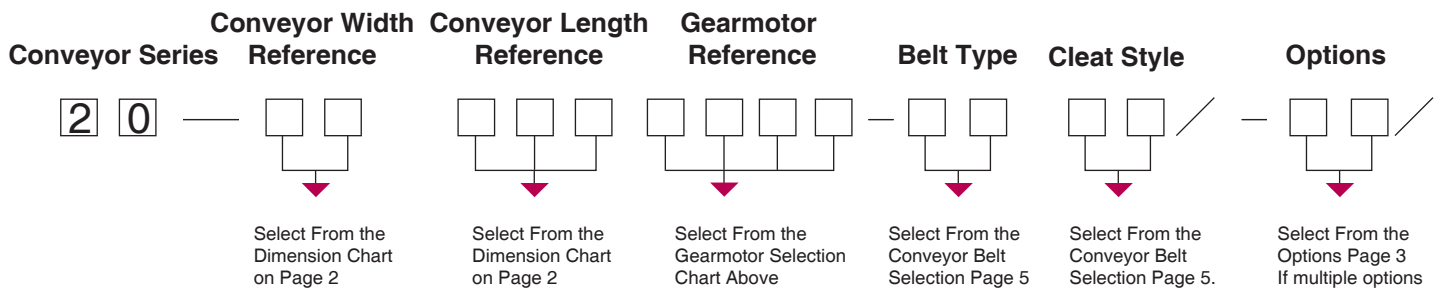

Example:

20-12096-006D-U1-V1/ 4"-OS/V2

This model no. designates a Lite Series conveyor with a width of 11.9", a nominal length of 96" and a white urethane belt with a .16" high cleat placed on 4" centers. The drive is fixed speed with a belt speed of 98 FPM. The options are Opposite Side, Drive Mounting and a motor with 230/60/3-phase voltage.

Modifications

Lite Series conveyors may be modified for extended lengths greater than 144", wash down, severe wet and dirty, and abrasive bulk product applications. Please consult with your representative for the Lite Series broad range of additional capabilities.

Standard Model Belt Selection

Belt Specifications	Standard Belting Materials					
	U1	U2	U3	U4	P1	P3
Top Cover	Urethane	Urethane	Fabric	Urethane	PVC	PVC
Lateral Stability	2 ply Polyester	2 ply Polyester	2 ply Polyester	2 ply Polyester	2 ply Polyester	2 ply Polyester
Bottom Side	Fabric	Urethane	Fabric	Fabric	Fabric	Fabric
Edges	Cut	Sealed	Cut	Cut	Cut	Cut
Color	White	White	White	White	Black	Dk Grey
Thickness	0.06"	0.06"	0.04"	0.06"	0.08"	0.16"
FDA Conformance	Yes	Yes	Yes	Yes	No	No
Temperature Range	-22°F to 176°F †	5°F to 176°F †	-4°F to 212°F	-22°F to 176°F †	32°F to 158°F	14°F to 140°F
Antistatic	Yes	Yes	Yes	Yes	Yes	Yes
Cut/Abrasion Resistance	Excellent	Good	Fair	Good	Good	Excellent
Top Surface	Low Gloss	Low Gloss	Fabric	Satin	Matte	Rough-Top
Top Adhesion/Friction	Medium	Medium	V-Low	Low	Low	V-High

† Temperature values are based on continuous or prolonged product contact that elevates or decreases belt material temperature. In applications where product contact is transitory, all belts will withstand product temperatures of up to 212°F. Contact your representative for application assistance.

Application Special belting is available to handle high temperatures, severe chemicals and ESD-rated belts for electronics. Consult with your representative.

Accumulation Belts - used primarily for product accumulation and product diverting for side-discharge

U3 Style

- ▶ Lowest coefficient of friction
- ▶ FDA conformance
- ▶ Urethane impregnated
- ▶ General transport, bakery for quick dough release

U4 Style

- ▶ Low coefficient of friction
- ▶ FDA conformance
- ▶ General food handling
- ▶ Plastic, molding & extruding

P1 Style

- ▶ Low coefficient of friction
- ▶ Minimal reflection for camera & laser inspection
- ▶ Product accumulation
- ▶ Inkjet & bar code printing

General Purpose Belt

U1 Style

- ▶ Versatile belt providing chemical, cut & abrasion and grease & oil resistance
- ▶ FDA conformance
- ▶ Medium friction surface

High Friction Belt

P3 Style

- ▶ Highest coefficient of friction
- ▶ Handles clean, dry products up to 25° inclines & maintains product position in horizontal applications
- ▶ Impact loading & cushioning

Sealed / Severe Duty Belt

U2 Style

- ▶ Top, bottom & edge sealed
- ▶ FDA and USDA conformance
- ▶ Food processing
- ▶ Metal working & stamping (oil saturated)

Cleated Belts

Cleats (carriers) are used for separating products, especially in incline & decline applications. Cleats are available on all U1, U2 & U4 style belts. Standard cleat styles are shown below. Although standard cleat heights offer the best pricing, cleats are available in any height up to 2.36." Placement of cleats on the belt length (separation) is restricted only by the minimum distance of 2.00". For T-cleat heights greater than 2.36" and for angled cleats, please contact your representative.

Cleat Style	H
H0	0.16"
H1	0.79"
H2	1.18"
H3	1.58"
H4	2.36"

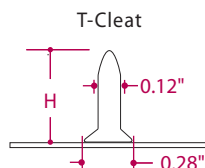

Standard Model Specifications

- Frame: 1.5" High hard-clear-anodized aluminum.
- Slider Bed: 3/8" polished aluminum
- Pulleys: 1.25" dia., precision crowned aluminum
- Pulley Bearings: Ball bearing, doubled sealed for life
- Accessory Mounting: Aluminum T-slot Profile
- Conveyor Belts: Select from a wide variety of smooth surface and cleated belts from the chart on page 5.
- Load Capacity: The LP series maximum load carrying capacity is 150 lb. Drive speed has an inverse effect on load capacity. To determine load carrying capacity at a specific speed, use the gearmotor selection chart on page 9.



- ◇ Notes: 1. T-slot Profile OAL is specific to conveyor length. For length detail, order Specsheet 40204. Profile may be removed. When removed, additional mount holes are available. For hole location and size detail, order Specsheet 40202.
 2. Mounting Hole Centerline: Mounting hole quantity & locations are conveyor length specific. For detail, order Specsheet 40201.

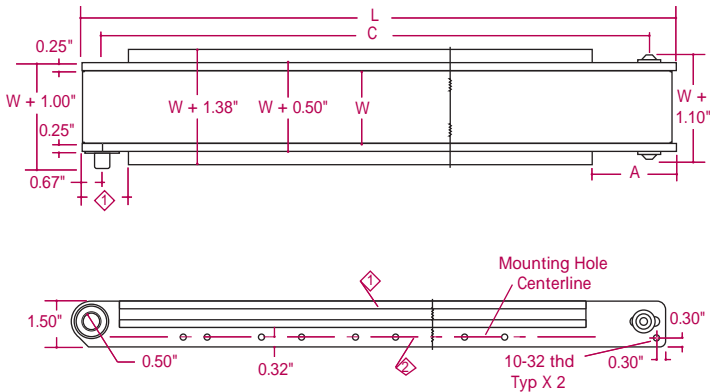

LP Series Conveyors - Standard Sizes					
Conveyor Length Reference	Nominal Conveyor Length (L)	Reference Dim. (A)	Pulley Centers (C)	Conveyor Width Reference	Conveyor Width (W)
018	17.50"	2.69"	16.15"	02	1.90"
024	23.30"	2.03"	21.92"	03	2.90"
030	29.33"	2.69"	27.79"	04	3.90"
036	35.35"	2.08"	33.98"	06	5.90"
042	41.00"	2.13"	39.80"	08	7.90"
048	47.43"	2.16"	46.04"	10	9.90"
060	59.06"	2.35"	57.85"	12	11.90"
072	71.15"	2.69"	69.91"	13	12.90"
084	83.30"	2.68"	82.00"	14	13.90"
096	95.39"	2.69"	94.06"	15	14.90"
108	107.48"	2.69"	106.12"	16	15.90"
120	119.57"	2.70"	118.18"		
132	131.66"	2.73"	130.24"		
144	143.66"	2.74"	142.30"		

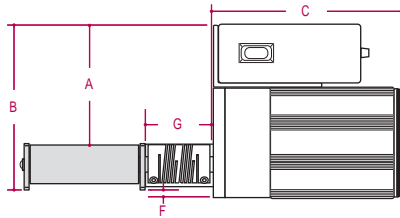

	A	B	C	D	E	F	G
1/30 HP	3.52"	5.05"	4.97"	1.17"	2.25"	0.15"	1.84"
1/18 HP	3.84"	5.37"	6.00"	1.17"	2.44"	0.23"	1.84"
1/12 HP	3.97"	5.50"	7.58"	1.17"	2.44"	0.23"	1.76"
1/8 HP	3.97"	5.50"	8.18"	1.17"	2.44"	0.23"	1.76"

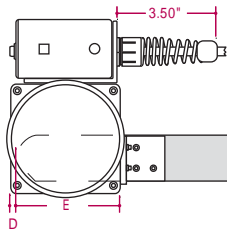

Drive Controls: Standard box with power switch & 7 ft cord with plug. Voltage 115/60/1. Available in right or left hand mount.

S Style - Side Mount

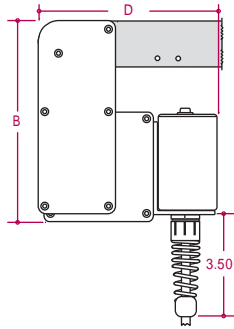
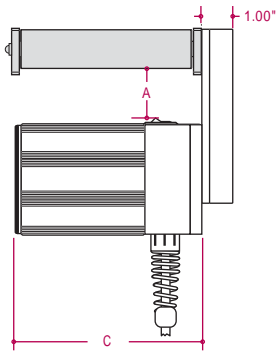

	A	B	C	D
1/30 HP	1.87"	6.65"	4.97"	5.47"
1/18 HP	1.87"	6.84"	6.00"	5.78"
1/12 HP	1.87"	6.84"	7.86"	5.91"
1/8 HP	1.87"	6.84"	8.44"	5.91"

Controls: Standard box with power switch & 7 ft cord with plug. Voltage 115/60/1. Available with drive belt cover on the left or right side.

X Style - Under Mount

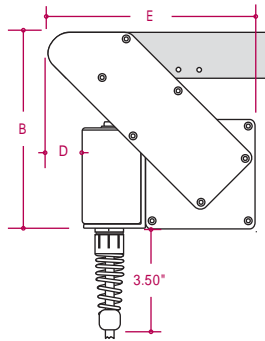
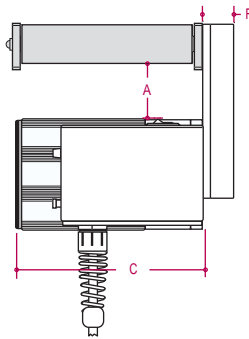

	A	B	C	D	E	F
1/30 HP	1.47"	6.25"	4.97"	1.27"	6.57"	1.00"
1/18 HP	1.59"	6.56"	6.00"	1.07"	6.64"	1.00"
1/12 HP	1.68"	6.66"	7.58"	1.07"	6.77"	1.25"
1/8 HP	1.68"	6.66"	8.18"	1.07"	6.77"	1.25"

Controls: Standard box with power switch & 7 ft cord with plug. Voltage 115/60/1. Available with drive belt cover on the left or right side.

U Style - Under Mount

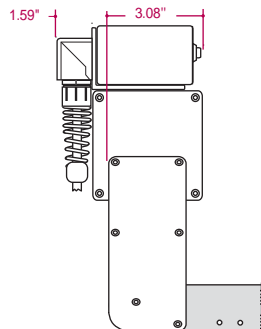
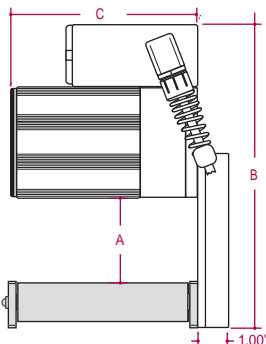

	A	B	C
1/30 HP	4.22"	10.97"	4.97"
1/18 HP	4.15"	11.28"	6.00"
1/12 HP	4.15"	11.41"	7.86"
1/8 HP	4.15"	11.41"	8.44"

Controls: Standard box with power switch & 7 ft cord with plug. Voltage 115/60/1. Available with drive belt cover on the left or right side.

Z Style - Over Mount



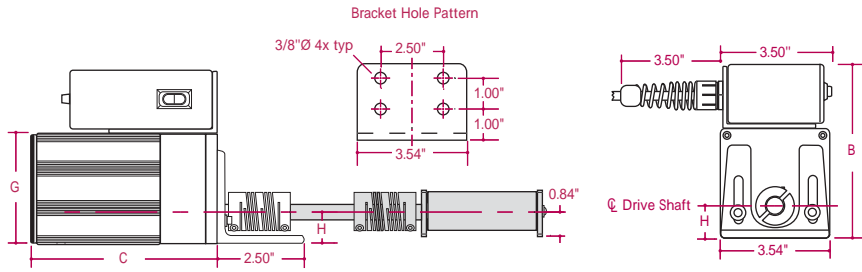

	H min	H max	B min	B max	C	G
1/30 HP	0.98"	1.98"	5.20"	6.20"	4.97"	3.15"
1/18 HP	1.06"	2.06"	5.59"	6.59"	6.00"	3.54"
1/12 HP	1.06"	2.06"	5.71"	6.71"	7.58"	3.54"
1/8 HP	1.06"	2.06"	5.71"	6.71"	8.18"	3.54"

Controls: Standard box with power switch & 7 ft cord with plug. Voltage: 115/60/1 VAC

R Style - Remote Mount



Variable Speed Drive Option

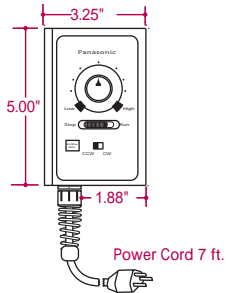

Variable speed drives are available for all LP Series Drive Packages. The drives are variable frequency and include the remote mount controller shown. The controller accepts 115 VAC input and inverts the output to 230/60/3 phase VAC. Dimensions for the variable speed motors with terminal box may be obtained by ordering Specsheat 40203

Inverter / Controller Overview

Inverter is designed exclusively to drive 3-phase induction motors. Combining a 3-phase induction motor with the inverter offers a wide working speed range.

Control Functions

Front Panel

- Run / Stop Switch
- CW / CCW Direction Switch
- Speed Control Potentiometer

External Control*

- Run / Stop
- Rotational Direction
- Free Run Stop

* Remote control functions require an additional cable Order P/N DVOP1390 5 - 5 meter length. Additional switches are required, but not included.

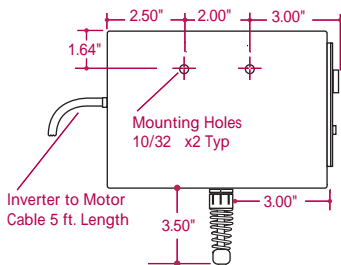

Variable Speed Drive Inverter Controller



Motor Terminal Box Option

LP Series Drive Packages illustrated on this and the preceding page are 115/60/1 VAC fixed speed drives with a control box including a power switch, LED indicator, overload fuse and power cord with plug. Dimensions for terminal box style gearmotors without controls including 115/60 VAC, 230/50/60 1-phase VAC and 230/60 3-phase VAC, may be obtained by ordering Specsheat 40203.

Not Cataloged Drive Options

A variety of not cataloged drives are available: DC inverter style, DC brushless, wash down, 1/6 HP to 3/8 HP inverter duty, and air motors. For application assistance, consult your representative.

Standard Drive Selection

Gearmotor Selection Steps

1. Using the Drive HP Selection Guide, select the required HP for the application load/speed.
2. From the Gearmotor Selection Chart, chose a fixed speed or variable speed gearmotor, meeting the application requirement.
3. Use the selected gearmotor reference number when building a conveyor ordering number.

Drive HP Selection Guide

Belt Speed FPM	Conveyor Load Lbs.												
	10	20	30	40	50	60	70	80	90	100	110	120	130
0-12													
16-23													
32-39													
47-65													
78-98													
117-150													

1/30 HP - 25 Watt A
1/18 HP - 40 Watt B
1/12 HP - 60 Watt C
1/8 HP - 90 Watt D

Note: Load carrying capacity is based on horizontal travel, uniformly distributed load over the usable belt length and the belt moving toward the drive. For inclined applications, for applications with the belt travel away from the drive end, and for application assistance on not cataloged drive packages, please consult your representative.

Gearmotor Selection & Order information

Fixed Speed				Variable Speed-Inverter Included			
Gearmotor Ref No.	HP	Torque In.-lb.	Belt Speed FPM	Gearmotor Ref No.	HP	Torque In.-lb.	Belt Speed FPM
075A	1/30	69	8	36VA	1/30	34	5 -15
050A	1/30	46	12	25VA	1/30	23	7 -22
036A	1/30	33	16	15VA	1/30	14	12 -37
025A	1/30	23	23	15VB	1/18	24	12 -37
015A	1/30	14	39	12VB	1/18	20	17 -44
036B	1/18	56	16	09VB	1/18	14	20 -61
025B	1/18	39	23	07VB	1/18	11	24 -74
015B	1/18	24	39	25VC	1/12	57	7 -22
012B	1/18	47	65	15VC	1/12	34	12 -37
025C	1/12	23	47	12VC	1/12	29	17 -44
015C	1/12	34	39	09VC	1/12	20	20 -61
012C	1/12	29	47	07VC	1/8	17	24 -74
009C	1/12	21	65	15VD	1/8	50	12 -37
015D	1/8	50	39	12VD	1/8	41	17 -44
012D	1/8	41	47	07VD	1/8	25	26 -74
009D	1/8	30	65	06VD	1/8	20	33 -92
007D	1/8	25	78	05VD	1/8	16	38 -110
006D	1/8	16	98	04VD	1/8	12	53 -155
004D	1/8	12	163				

LP Series, Drive Package Ordering Chart

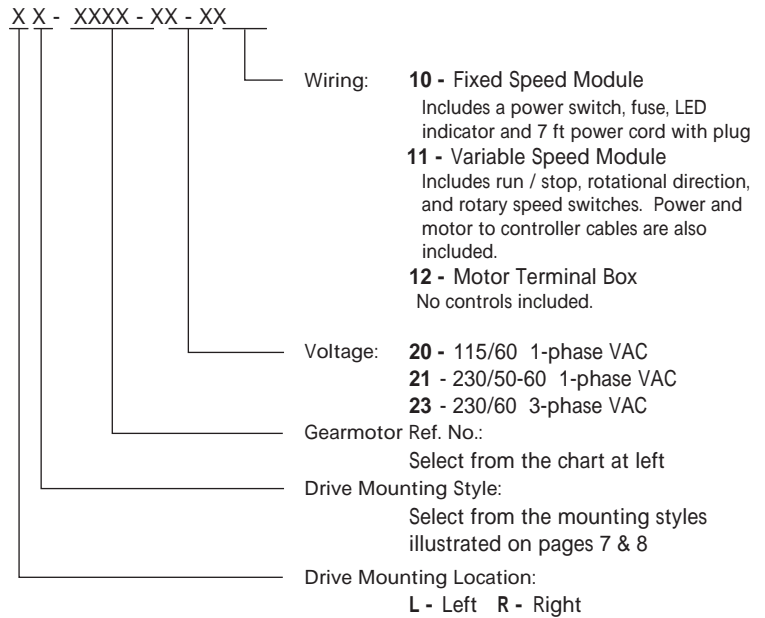

Example : LZ-15VD-20-11

This model number designates an LP Drive Package with a 1/8 HP, variable speed, gearmotor, 115/60/1 VAC input voltage, a 90 degree over mounting style on the left side.

Note: The number in the Gearmotor Ref. No. located in the chart to the left, represent the gear head ratio, except, 04, which is a 3.6/1 ratio.

Conveyor Options

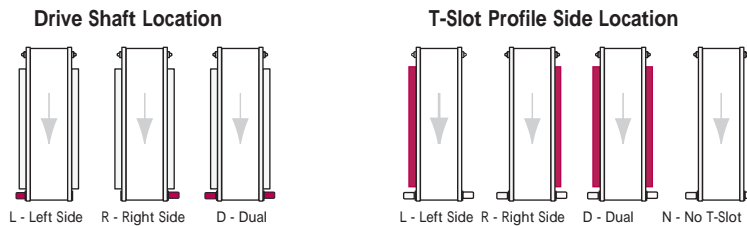

LP Series, Conveyor Ordering Chart

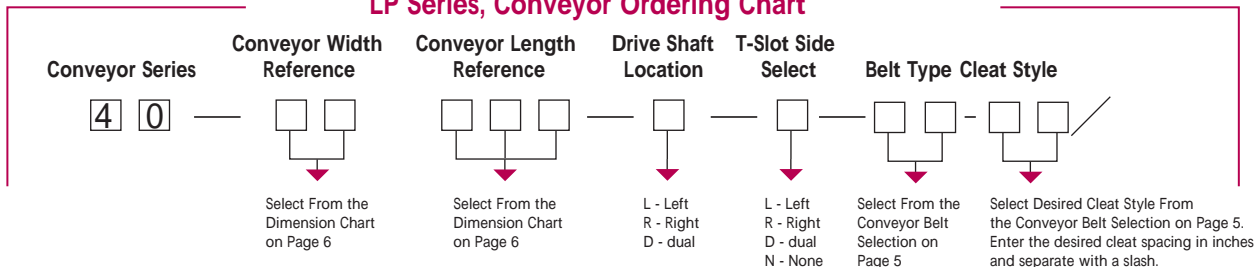

Fixed Side Guides (LP Series)

Standard side guides are constructed of aluminum with a brush finish. They are also available with with 0.030" laminated UHMW product guide surface. Guides may be installed with or without the T-slot Profile and are sold per side by the conveyor length model. Order 2 each when both sides are required. EXAMPLE: A 1.5" high side guide with UHMW guide surface on both sides of a 042 length reference conveyor. Order 2 each 40-7262-42

Aluminum Guide Part Number	Aluminum Guide with UHMW Product Guide
40-7221 - 1.00" high	40-7261 - 1.00" high
40-7222 - 1.50" high	40-7262 - 1.50" high
40-7223 - 2.00" high	40-7263 - 2.00" high
40-7225 - 2.50" high	40-7264 - 2.50" high
40-7226 - 3.00" high	40-7265 - 3.00" high
40-7227 - 4.00" high	40-7266 - 4.00" high



Adjustable Guide Rails (LP Series)

Adjustable rail brackets utilize the Conveyor T-slot Profile for mounting and are available in three styles with each style offering multiple adjustment ranges. The 1/8" and 1/4" brackets are constructed using two aluminum L brackets. The Quick Adjust bracket is constructed of aluminum brackets and stainless steel adjustment rods and are available with optional quick-adjust t-handles. Guide rails are constructed of UHMW with a stainless steel mounting support and are available in five widths. Brackets are sold individually and rails are sold by the foot.



1/8" Brackets

1/4" Brackets

Quick Adjust Brackets

Brackets

Bracket Style	Part No.	LH	HH	IF	OF
1/8" Aluminum	40-7205	0.75"	4.25"	3.50"	3.00"
1/8" Aluminum	40-7206	0.75"	5.25"	4.50"	3.75"
1/4" Aluminum	40-7212	0.50"	0.75"	1.00"	0.75"
1/4" Aluminum	40-7213	0.75"	3.25"	2.00"	0.37"
1/4" Aluminum	40-7214	0.75"	5.25"	2.00"	0.37"
Quick Adjust	40-7251	0.50"	2.75"	2.25"	0.75"
Quick Adjust	40-7252	0.50"	4.75"	4.25"	0.75"
Quick Adjust	40-7253	0.50"	6.75"	6.25"	0.75"
Quick Adjust	40-7254	0.50"	8.75"	8.25"	0.75"

Rails

Rail Width	Part No.
0.50"	40-7231
1.00"	40-7232
1.25"	40-7233
1.60"	40-7234
2.25"	40-7235

Dual Rail Bracket

Part No.
40-7237

Mounts two rails with a 2.50" rail separation.

Note: Adjustment values shown are measured from the centerline of the mounted rail to the conveyor belt surface for height and from the mounted rail face to the inside edge of the conveyor side frame for width. Abbreviations: LH = low height, HH = high height, IF = inside the frame & OF = Outside the frame.

Accumulation Part Stop

Part stops are available in two styles. The Lite Series stop mounts to 10/32 thd holes at the conveyor idler or drive ends. The LP Series stop mounts to the T-slot profile and the stop may be located at any point along the belt length. Stops are constructed of 1/2" thk x 2.00" height PVC and utilize aluminum brackets for mounting.



Lite Series Stop



LP Series Stop

Conveyor Width Ref.	02	03	04	06	08	10
LP Series Part No.	40-7050	40-7051	40-7052	40-7053	40-7054	40-7055
Lite Series Part No.	20-7034	20-7035	20-7036	20-7037	20-7038	20-7039
Conveyor Width Ref.	12	13	14	15	16	
LP Series Part No.	40-7056	40-7057	40-7058	40-7059	40-7060	
Lite Series Part No.	20-7040	20-7041	20-7042	20-7043	20-7044	

Couplers & Drive Shaft (LP Series)

Gang & remote drive connection components



Drive Shaft

Part No. 40-7211
0.50" dia, 303 stainless steel. Sold by the inch.

Couplers

Style	Part No.	Description
Helical	40-7201	Light Duty, 0.50" x 0.500" ID, 1.125" OD x 1.50" Long
Helical	40-7202	Light Duty, 0.50" x 0.625" ID, 1.125" OD x 1.50" Long
Helical	40-7203	Med. Duty, 0.50" x 0.500" ID, 1.125" OD x 1.75" Long
Helical	40-7204	Med. Duty, 0.50" x 0.625" ID, 1.250" OD x 1.75" Long
Lovejoy	40-7242	Heavy Duty, 0.50" x 0.500" ID, 1.10" OD x 1.75" Long
Lovejoy	40-7243	Heavy Duty, 0.50" x 0.625" ID, 1.10" OD x 1.75" Long

Product Indexing Timer

Independent control of belt movement & stop by time. Timing ranges from 0.10 second to 1 hour. Heavy-duty, long life relay output. LED power and relay on indicators. Aluminum enclosure with power switch, conveyor plug receptacle and 7 ft. power cord.

Part No. 30-7012



Product Guide Cushion

PVC extrusion snaps over Lite Series side frame. Prevents sensitive part damage. Custom cut to length & height. Sold by the foot installed.

Part No. 30-7011



Mounting Brackets



LP Series Frame Mount

L Bracket, 0.125" aluminum. Mounts to existing 10-32 holes. Conveyor installation hardware included.

Part No.	Size:	Adjustable Height
40-7034	0.625" x 1.50"	Fixed 1.50"
40-7035	2.00" x 1.5"	LH = 2.37", HH = 2.87"

Adjustment values stated are measured from the mounting surface to the conveyor belt surface. Abbreviations: LH = low height & HH = high height

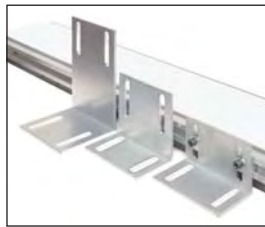

LP Series T-Slot Mount

L Bracket, 0.125" aluminum. Mounts to the T-Slot Profile. Conveyor installation hardware included.

Part No.	Size	Adjustable Height
40-7031	2" x 3"	LH = 1.63", HH = 3.12"
40-7032	2" x 4"	LH = 2.62", HH = 4.12"
40-7033	3" x 5"	LH = 3.62", HH = 5.12"

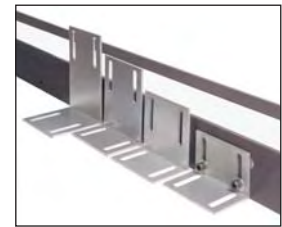

Lite Series Frame Mount

L Bracket, 0.125" aluminum. Mounts to existing 1/4-20 hole pattern. Conveyor installation hardware included.

Part No.	Size	Adjustable Height
20-7030	2" x 2"	LH = 1.82", HH = 2.00"
20-7031	2" x 3"	LH = 2.44", HH = 4.00"
20-7032	2" x 4"	LH = 3.57", HH = 5.00"
20-7033	3" x 5"	LH = 4.57", HH = 6.00"

Universal, Vertical Surface Mount



Mounts to existing frame holes on either Lite or LP Series Conveyors. Mounting arm rotates for incline applications. Conveyor installation hardware included.

Width	Model	Part No.
02 to 12		30-7081
13 to 16		30-7082

T-Nuts

T-Nuts facilitate attaching accessories to the LP Series T-Slot Side Profile

Part No.	Size
40-7041	10-32 thd
40-7042	1/4-20 thd

Conveyor Stands

Leg Stand

Heavy-Duty aluminum construction, 22" base width with leveling feet. Designed for all Mini-Mover conveyor widths to 16". Standard adjustable heights are available from 13" to 52" in six inch increments. Conveyor bracket mounting is angle adjustable for incline / decline applications to 40 degrees. Consult your representative for incline applications for LP Series conveyors. Cross braces for added stability and locking casters are available options.

Ordering Information - Leg Stands

Part No	Adjustable height	T.O.B.
30-7051	13" to 16"	
30-7952	16" to 22"	
30-7053	22" to 28"	
30-7054	28" to 34"	
30-7055	34" to 40"	
30-7056	40" to 46"	
30-7057	46" to 52"	

Ordering Information - Options

Part No.
30-7060 to 30-7064 Cross Brace
Increased stability for two leg applications. Recommended for conveyor lengths > 42". Consult your representative to determine the correct length.
30-7066 Locking Caster Assembly
Sold in pairs. Adds 3.4" to leg stand adjustable height and 4.5" to the base width.



Two Leg Stands with cross brace option

Conveyor Stands

Base Turn Stand

Aluminum construction, 28" base length. To determine stand width, add 1.87" to the conveyor width. Base turned parallel to conveyor achieves small footprint. Designed for light-duty application and is not recommended for conveyor lengths > 48". Adjustable heights are available from 13" to 34" :



Ordering Information

Part No.

30-7551 - Adjustable height 13" to 16" T.O.B.

30-7552 - Adjustable height 16" to 22" T.O.B.

30-7553 - Adjustable height 22" to 28" T.O.B.

30-7554 - Adjustable height 28" to 34" T.O.B.

Single Base Stand

Heavy-duty aluminum construction. 22" wide x 28" long base with angled bracing and leveling feet. Fits conveyor widths to 16" and is height adjustable from 32.5" to 48". Conveyor mounting bracket is angle adjustable for incline / decline applications to 40 degree. Optional locking casters available.



Ordering Information - Stand

Part No.

30-7073 - Adjustable height 32" to 36" T.O.B.

30-7075 - Adjustable height 36" to 40" T.O.B.

30-7076 - Adjustable height 40" to 44" T.O.B.

Ordering Information - Option

Part No.

30-7066 Locking Caster Assembly

Sold in pairs. Adds 3.4" to stand adjustable height & 4.5" to base length

Steel Base Stand

Heavy-duty 20" sq. steel base acts as counterweight. Features 36" aluminum upright, mounting arm, and leveling feet. Fits conveyor widths up to 16" and is height adjustable from 14" to 37" T.O.B.. Incline angle adjustable to 40 degrees. Mounting arm may be located on any side of the upright column, but certain locations may require additional counterweight. Optional locking casters available.



Ordering Information - Stand

Part No.

30-7072 - Adjustable height 14" to 37" T.O.B.

Ordering Information - Option

Part No.

30-7078 Locking Caster Assembly

Sold in sets of four. Adds 3" to stand adjustable height.

Specials Inquiry Form

This catalog has detailed specifications and part numbers for the Lite & LP Series, Mini-Mover Conveyors. In addition, Mini-Mover Conveyors manufactures specialty conveyors and rotary accumulation equipment to customer specific requirements. For rapid response to your specials requirement, simply provide the following information.

Company _____ Date _____
Name _____ Phone _____ Fax _____
Address _____ City _____ State _____

COPY THIS FORM AND COMPLETE THE INFORMATION AS IT APPLIES TO EACH PRODUCT

CONVEYOR SELECTION:

Center Drive Extended Modular Length (>12 feet) O-ring Style
Stainless Steel Magnetic Submersible
Length _____ Width _____ Belt Type _____ O-ring Diameter _____

CONVEYOR DRIVE SELECTION:

Electric Gearmotor Pneumatic Gearmotor
Side Mount Over Mount Under Mount
Fixed Speed Variable Speed (DC) Variable Speed (AC)
Input Voltage _____ Available CFM _____ PSI _____
Conveyor Loading (lbs..) _____ Belt Speed _____ (feet per minute)

CONVEYOR ACCESSORIES:

Leg Stand Supports _____ Height to top of belt Side Guides
Adjustable Guide Rails End Stop Stop with Gate (Cleated Belt)
Additional requirements _____

ROTARY ACCUMULATOR SELECTION:

Table Style Bucket Style (Programmable Count)
Table Diameter: 24 inch 32 inch 48 inch
Rotation Speed (rpm) _____ Estimated Load (lbs..) _____ Table Height _____

APPLICATION ASSISTANCE

Feel free to contact Mini-Mover Conveyors for assistance. Experienced applications engineers and technical sales associates are ready to help -- 7:30 AM to 4:30 PM Pacific Time

FAX COMPLETED FORM TO: (866) 900-5124



a division of Whipple Enterprises, Inc -- 21150 Shake Ridge Rd. -- Volcano, CA 95689
Phone: 800-586-4585 Fax 866- 900-5124
Web Site: mini-mover.com E-mail: info@mini-mover.com

Your Mini-Mover Conveyors Distributor

Mini-Mover Conveyors Div, Whipple Enterprises, Inc.
21150 Shake Ridge Road -- Volcano, CA 95689
Tel: (800) 586-4585 -- Fax: (866) 900-5124

Whipple Ent., Inc. reserves the right to change or discontinue products and specifications with or without notice. All products are covered in accordance with our standard warranty.

© Whipple Enterprises, Inc. 2005. All rights reserved